



# NIKE STAR

Wall-hung combi boiler  
open chamber  
conventional flue



## COMPACT SHAPED TECHNOLOGY

The range of STAR combi boilers is characterized by the **extremely compact dimensions**, the modern and elegant design and the **great performances**. The **low consumption pump** has settings directly on the circulator. The sober and essential aesthetics of the boiler features a control panel with descriptive icon knobs and an innovative backlit digital display, ensuring an easy and immediate use of the managing functions. **Bottom aesthetic cover (for cover the connection pipes) is supplied as standard.**

## FAST DOMESTIC HOT WATER SUPPLY

The STAR range is equipped with a **bithermal heat exchanger** and integrates both the heating and the domestic hot water production circuits. Therefore, the heat exchanger guarantees fast hot water supply and considerable simplification of the hydraulic circuit, all in favour of reliability and maintenance easiness.

## HYDRAULIC CONNECTIONS

The hydraulic connection kit is optional. NIKE STAR 24 presents same hydraulic and gas connection positions as current models.

OPTION KITS	Code
<b>MINI CRD</b> (Mini Digital Remote Control)* Product class V* or VI; seasonal energy efficiency value 3% or 4%	3.020167
<b>CAR<sup>v2</sup></b> (weekly thermostat and modulating remote control) Product class V* or VI; seasonal energy efficiency value 3%* or 4%	3.021395
<b>Connection kit</b>	3.015229

\* These remote controls are combinable exclusively with single zone systems.

Technical data	Unit of measurement	NIKE STAR 24
Code	N.G.	3.027062
Code	L.P.G.	3.027062GPL
CE certificate		51CS4790
Maximum nominal heat input	kW	25,9
Minimum heat input (D.H.W. / C.H.)	kW	8,1 / 10,8
Maximum nominal heat output	kW	23,6
Minimum nominal heat output (D.H.W. / C.H.)	kW	7,0 / 9,5
Efficiency at 100% nominal heat output	%	91,1
Efficiency at 30% nominal heat output load	%	86,6
Gas flow rate burner ON (with natural gas) max/min	m <sup>3</sup> /h	2,74/0,86
D.H.W. flow rate for continuous service (Δt 30 °C)	l/min	11,1
Central heating expansion vessel capacity	litres	6
Electric protection index	IP	X4D
Full appliance weight (empty)	kg	25,3 (24,6)

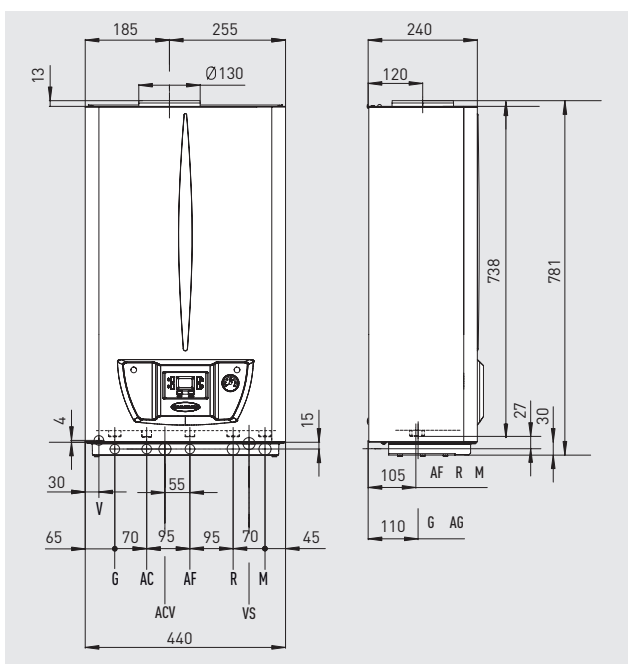

### Key

V	Electrical connection
G	Gas supply
AC	Domestic hot water outlet
ACV	Solar valve domestic hot water inlet
AF	Domestic cold water inlet
R	System return
VS	Safety valve drain
M	System flow

### Hydraulic connections

Gas	D.H.W.		System	
G	AC	AF	R	M
3/4"	1/2"	1/2"	3/4"	3/4"

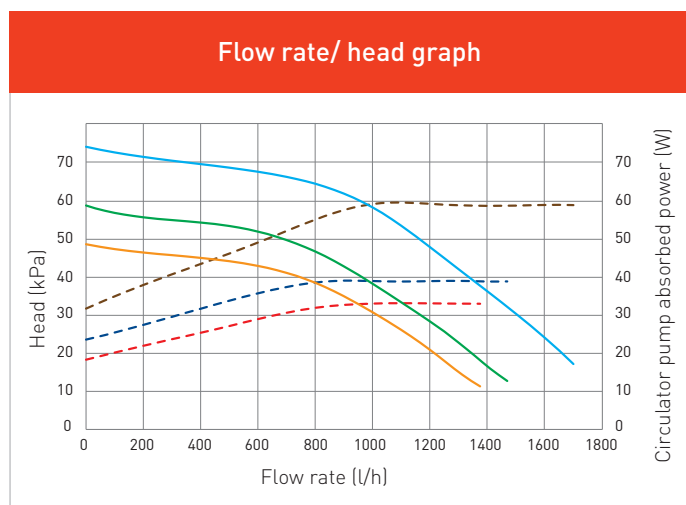

### Key

- Available head at 2<sup>nd</sup> speed
- Available head at 3<sup>rd</sup> speed
- Available head at 4<sup>th</sup> speed
- - Pump consumption at 2<sup>nd</sup> speed
- - Pump consumption at 3<sup>rd</sup> speed
- - Pump consumption at 4<sup>th</sup> speed

NIKE STAR boilers are equipped with adjustable system by-pass.

We recommend regular periodic maintenance of the appliance.

**IMMERGAS**  
IMMERGAS SPA - ITALY  
CERTIFIED COMPANY  
UNI EN ISO 9001:2008

Design, manufacture and post-sale assistance of gas boilers, gas water heaters and related accessories

Immergas S.p.A. 42041 Brescello (RE) - Italy - T. 0522.689011 F. 0522.680617

presales-export@immergas.com

immergas.com



App Immergas TOOLBOX

